

CONTENTS



OVERRUN BRAKE COUPLING, FOR V-TYPE DRAWBAR 2.1



OVERRUN BRAKE COUPLINGS, FOR V-TYPE DRAWBAR - CAST-IRON BODY 2.2



OVERRUN BRAKE COUPLINGS, FOR SQUARE SECTION DRAWBAR 2.3



Ø50 BALL COUPLING HEAD - TOWING EYES 2.4



BRAKED ADJUSTABLE DRAWBARS, WITH LIFT AND ASSISTANCE 2.5



LIFT AND DOWN BRAKED DRAWBAR, WITH CRANK 2.6



OVERRUN BRAKE COUPLINGS, WITH SQUARE DRAWBAR 2.7



V-TYPE DRAWBAR 2.8



INERTIA BRAKING SYSTEM HYDRAULIC TRANSMISSION 2.9



AXLES WITH HYDRAULIC BRAKES 2.10

OVERRUN BRAKE COUPLING, FOR V-TYPE DRAWBAR

from 750 kg to 2700 kg

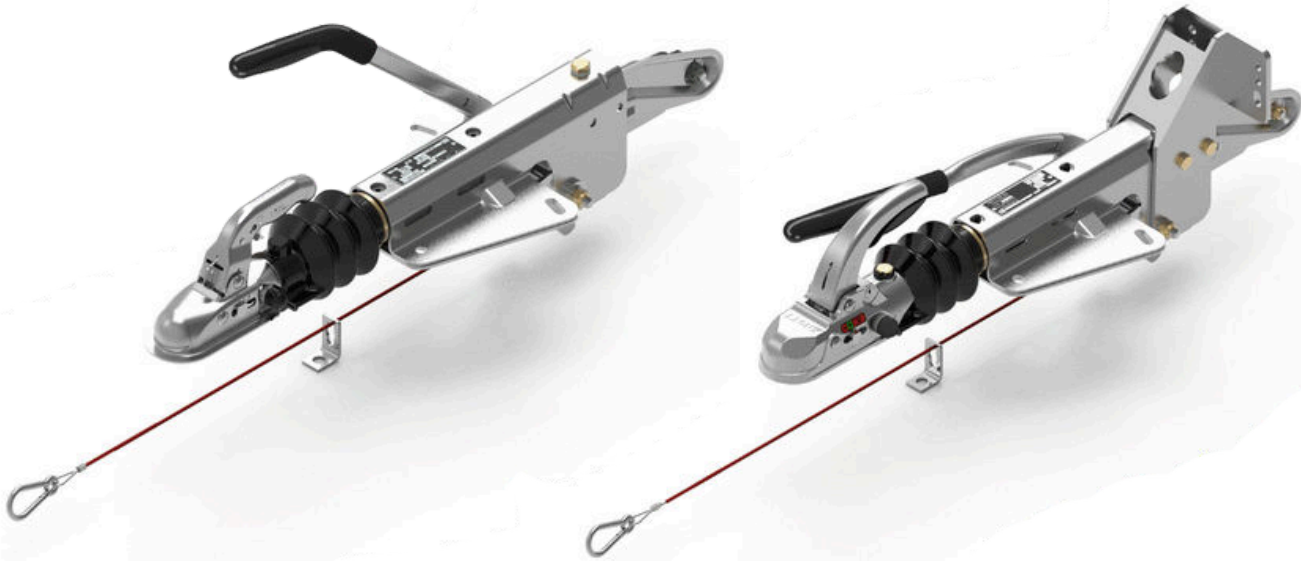

Sur demande
Anneau DIN Anneau NATO

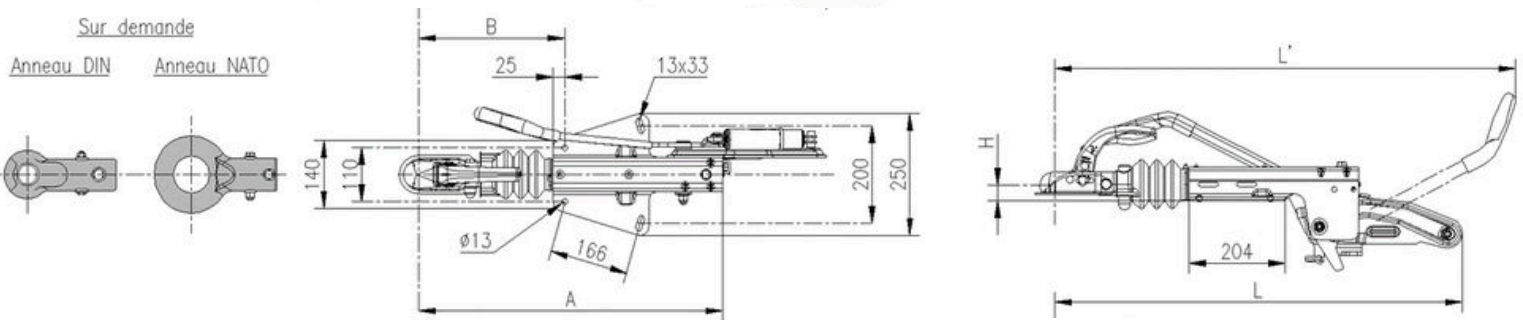

REF.	TYPE	GVW kg	VERTICAL LOAD kg maxi	SLIDING TUBE	DIMENSION (±10mm)					Weight kg
					A	B	H	L	L'	
1200310	KF7.5C	375-750	75	Ø45	649	313	34	867	990	16
1200311	KF13C	750-1300	100	Ø45	649	313	34	867	990	16
1200646	KF13C (1)	750-1300	100	Ø45	649	313	34	867	990	16.8
1200313	KF20A	1300-2000	100	Ø45	649	313	34	867	990	17.2
1200647	KF20A (1)	1300-2000	100	Ø45	649	313	34	867	990	20.7
1200664	KF27B (2)	1400-2700	150	Ø50	673	300	23	874	965	25.5

(1) : Equipped with rear Jockey Wheel support (J.W. Ref. 1200328)

(2) : Equipped with side Jockey Wheel support (J.W. Ref. 1200357)

If mounted on a plate, provide two 15mm shims Ref. 3230528

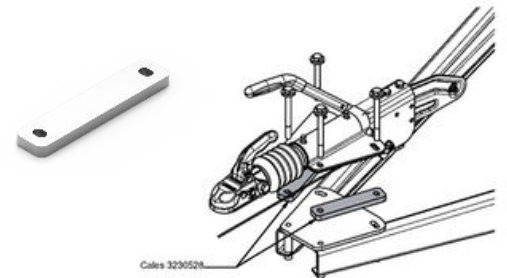

NOTA : DIN TOWING EYE (Ø40) ; BNA (68x42) OR NATO (76x42) ON DEMAND

ALL OUR KNOTT BRAND OVERRUN COUPLINGS ARE HOMOLOGATED (R13-R55)

OVERRUN BRAKE COUPLINGS, FOR V-TYPE DRAWBAR - CAST-IRON BODY

from 1400 kg to 3500 kg

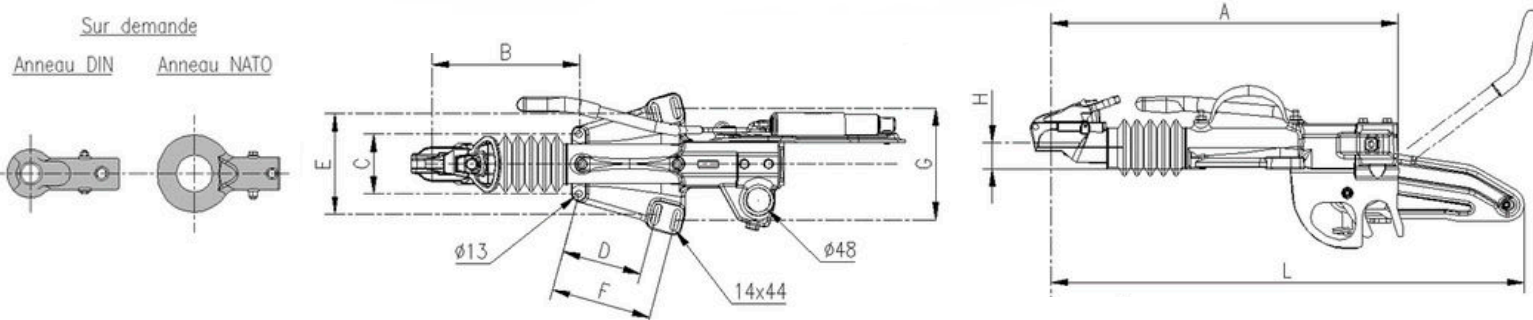

WITH STANDARD ANTITHEFT LOCK AND JOCKEY WHEEL SUPPORT (J.W. Ref. 1200357)

REF.	TYPE	PTAC kg	VERT. LOAD kg	SLIDING TUBE	DIMENSION ($\pm 10\text{mm}$)									Weight kg
					A	B	C	D	E	F	G	H	L	
1200368	KFG27A1	1400-2700	150	$\text{\O}50$	655	283	120	-	-	166	210	36.5	-	23.5
1200669	KFG30A	1600-3000	150	$\text{\O}50$	655	283	120	-	-	166	210	36.5	-	23.5
1200338	KFG35D	2700-3500	150	$\text{\O}60$	714	303	120	166	200	207	225	51.5	977	36.5

NOTA : DIN TOWING EYE ($\text{\O}40$) ; BNA (68x42) OR NATO (76x42) ON DEMAND

ALL OUR KNOTT BRAND OVERRUN COUPLINGS ARE HOMOLOGATED (R13-R55)

OVERRUN BRAKE COUPLINGS, FOR SQUARE SECTION DRAWBAR

from 750 kg to 3500 kg



Sur demande
Anneau DIN Anneau NATO

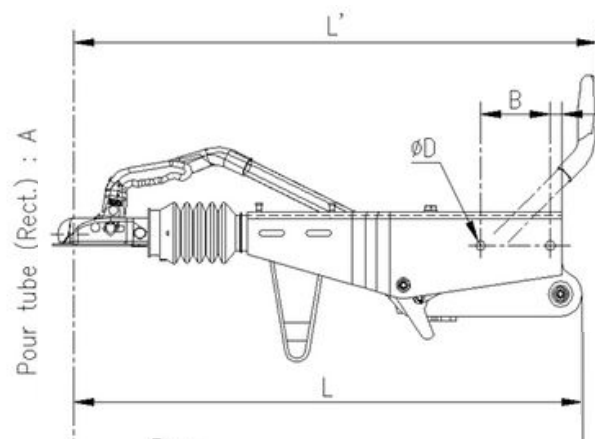
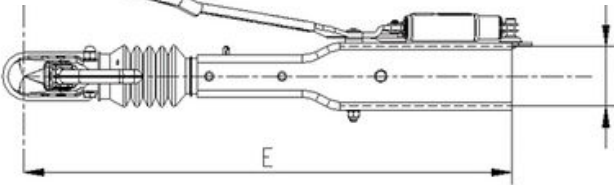
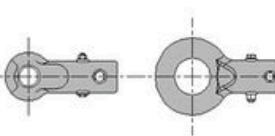

REF.	TYPE	GVW kg	VERT. LOAD kg maxi	SLIDING TUBE	DIMENSION (±10mm for E, L and L')							Weight kg
					A	B	C	D	E	L	L'	
1200334	KRV7.5C	375-750	75	Ø45	60	120	15	13	817	852	900	17.5
1200332	KRV13C	750-1300	100	Ø45	70	120	15	13	817	852	900	18.5
1200333	KRV20A	1100-2000	100	Ø45	100	120	20	16.5	853	878	977	19
1200633	KRV30B	1600-3000	150	Ø50	100	120	20	16.5	954	989	989	24.5
3230692	KRV35A	2700-3500	250	Ø60	120	400	30	16.5x3	1010	1010	1037	34.5

NOTA : DIN TOWING EYE (Ø40) ; BNA (68x42) OR NATO (76x42) ON DEMAND

ALL OUR KNOTT BRAND OVERRUN COUPLINGS ARE HOMOLOGATED (R13-R55)

Ø50 BALL COUPLING HEAD - TOWING EYES

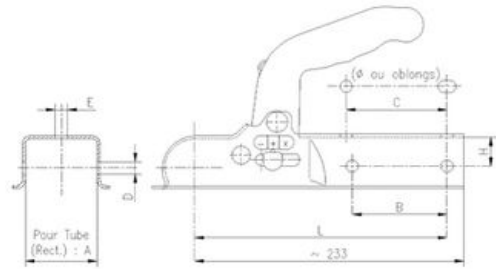

REF.	TYPE	FIXATION A	GVW kg	VERT. LOAD kg maxi	DIMENSION and FIXATION						Weight kg
					B	C	D	E	H	L	
1200928	K7.5K	50	750	75	80	85	Ø10.5	Ø10.5x15.5	25	204	1.5
1200626	K7.5O	60	750	75	80	85	Ø10.5	Ø10.5x15.5	25	213	1.5
1200365	KQ14A	50	1400	100	90	90	Ø12.5	Ø12.5	17	213	1.8
1200366	KQ14B	60	1400	100	90	90	Ø12.5	Ø12.5	17	213	1.8

OTHER TYPES AVAILABLE ON DEMAND : PLEASE CONSULT US

Heads for couplings and drawbars

Adapter 1200428



Ø45/50

For Draw tube	GVW kg max			With standard antitheft lock	
Ø45	1300	1200420	-	-	-
Ø45	2000	1200421	1200424 (delivered with Adapter)	-	-
Ø50 (2xØ12.5)	2700	-	1200424	1200427	-
Ø50 (2xØ14.5)	3000	-	1200660	1200427-14	-
Ø60	3500	-	1200402	-	1200425

Towing eyes for couplings and drawbars



For Draw tube	DIN Towing eyes (Ø40)		NATO (76x42)	BNA (68x42)	NATO (76x42)	BNA (68x42)
Ø45	1200460	-	1200465	1200467	-	-
Ø50*	1200461* (2xØ12.5)	-	1200466*	1200468*	-	-
Ø60	-	1200463	-	-	1200464	1200598

* Ø50 1200461 (2xØ12.5); 1200466 and 1200468 (2xØ14.5)

ALL OUR KNOTT BRAND HEADS AND TOWING EYES ARE HOMOLOGATED (R55)

BRAKED ADJUSTABLE DRAWBARS, WITH LIFT AND ASSISTANCE

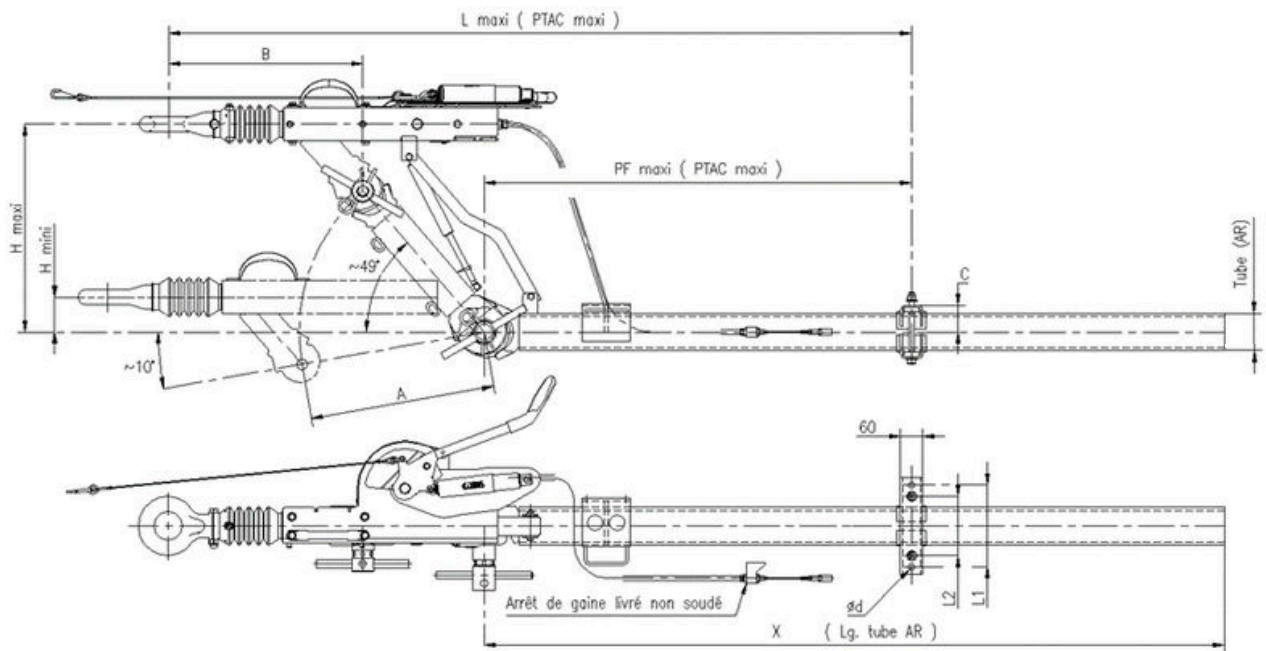

REF. with 68x42 eye	TYPE	GVW kg	A mm	B mm	H mini/maxi	Rear Tube mm	X mm	L maxi mm	PF maxi mm	C mm	Ød mm	L1/L2 mm	Weight kg
3230001.003	KHA13 C	750-1400 (1)	500	485	73/537	Ø88.9x8	2000	2115	1300	60	14.5	160	88
3230002.003	KHA20 A	1100-2000	500	480	76/535	Ø101.6x10	2000	2133	1320	66	13	200	116
3230011.003	KHA30 A	1500-2600	500	525	93/555	100x100x8	2000	2007	1150	71	18	220/160	138
3230003.003	KHA30 B	2500-3000	500	525	93/555	100x100x8	2000	1739	885	71	18	220/160	138
3230004.003	KHA35 B	2700-3500	700	515	63/713	160x90x6.3	2000	1995	1020	71	18	220/160	169

(1) : Without assistance

NOTA : DIN TOWING EYES (Ø40) ; BNA (68x42) OR NATO (76x42) ON DEMAND

ALL OUR KNOTT BRAND OVERRUN COUPLINGS ARE HOMOLOGATED (R13-R55)

LIFT AND DOWN BRAKED DRAWBAR, WITH CRANK

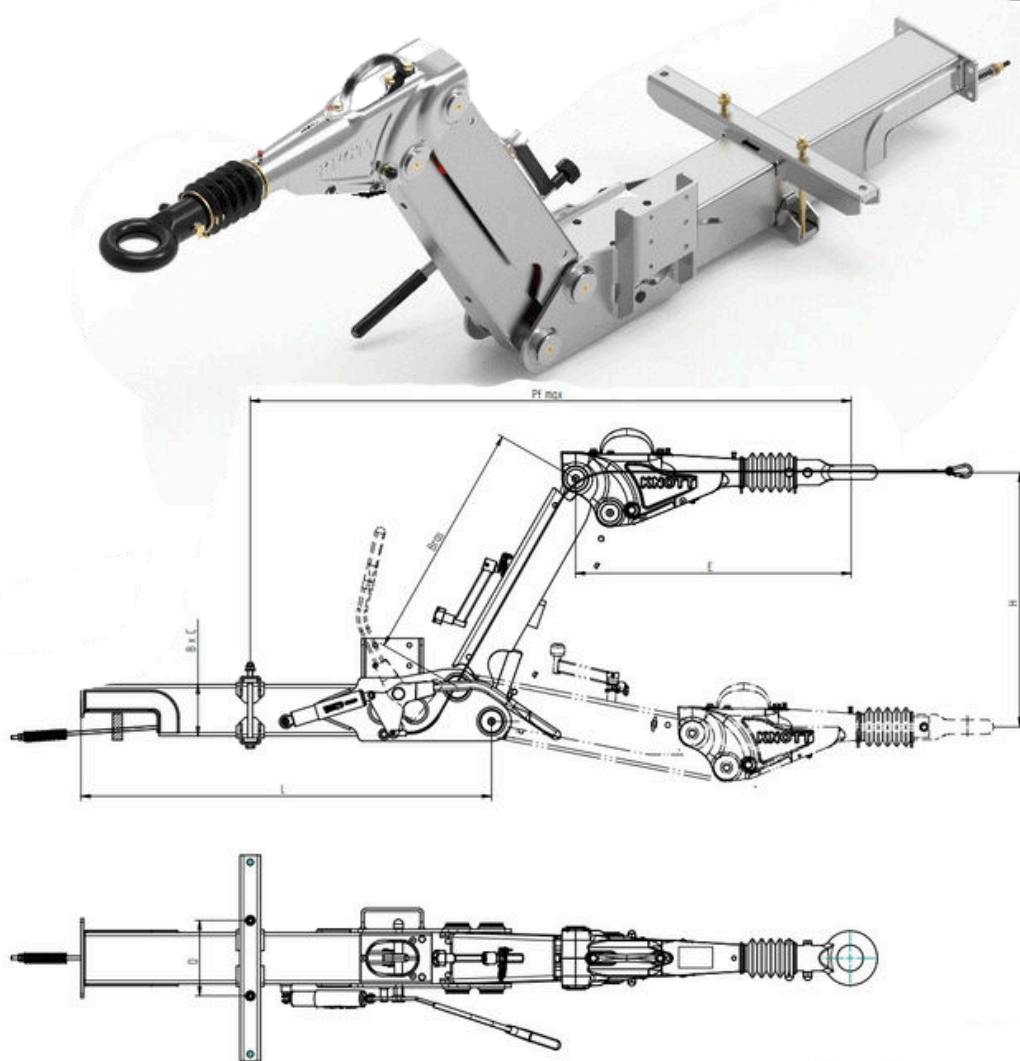

WARNING : Adjust the coupling height ONLY when the trailer is not yet hitched to the towing vehicle!

Once the drawbar is hitched to the vehicle, turning the crank is **PROHIBITED!**

Tilting the trailer by turning the crank is **STRICTLY PROHIBITED!**

TYPE	GVW range in kg	Rear Tube profil	D	ARM lg	Height H en mm	E	FDL PF maxi	Weight L=2000
KHD 9	500-900	80x120	160	500	520	609	2500	63
KHD 15	800-1600	90x90	160	500	536	641	2395	78
KHD 15	800-1600	90x90	160	700	704	720	2075	88
KHD 25	1600-2500	120x120	180	700	725	683	2583	131
KHD 35	2500-3500	150x150	220/560	700	727	701	2511	152

CONFIGURATIONS AVAILABLE ON DEMAND : PLEASE CONSULT US

ALL OUR KNOTT BRAND OVERRUN COUPLINGS ARE HOMOLOGATED (R13-R55)

OVERRUN BRAKE COUPLINGS, WITH SQUARE DRAWBAR

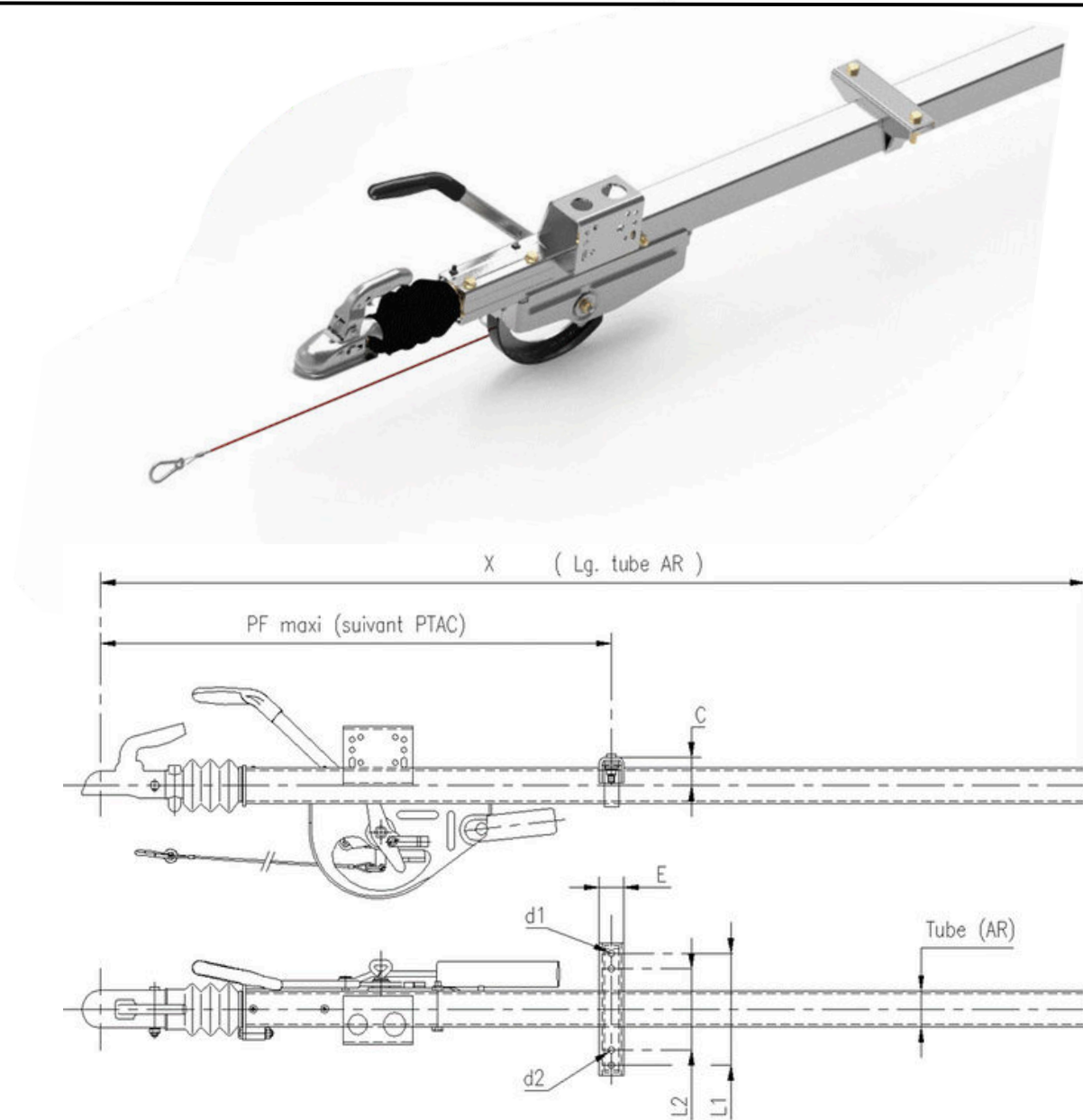

REF. for Ball Joint	LOAD kg	GVW mini-maxi kg	VERT. LOAD kg maxi	Rear Tube mm	X mm	Max Drilling diam (mm)		C mm	E mm	d1 mm	d2 mm	L1/L2 mm	Weight kg
						GVW min	GVW maxi						
3230023	KV13 C2	750-1400	100	70x70x4	2520	2058	1235	55	50	13x25	-	160	35
3230024	KV18 C4	1100-2000	100	70x70x5	2600	1893	1044	55	50	13x25	-	160	40
3230026	KR30 A1	1500-2600	150	90x90x6.3	2500	2796	1658	73	60	Ø15	Ø18	160/220	105
3230027	KR30 B1	2500-3000	150	90x90x6.3	2500	1723	1436	73	60	Ø15	Ø18	160/220	105
3230032	KR35 D	2700-3500	350	100x100x8	3000	2365	1845	71	60	Ø15	Ø18	160/220	130

ALL OUR KNOTT BRAND OVERRUN COUPLINGS ARE HOMOLOGATED (R13-R55)

V-TYPE DRAWBAR

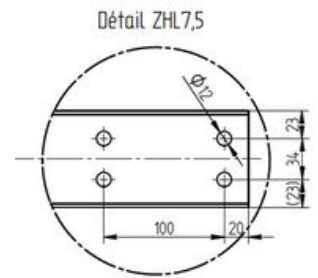
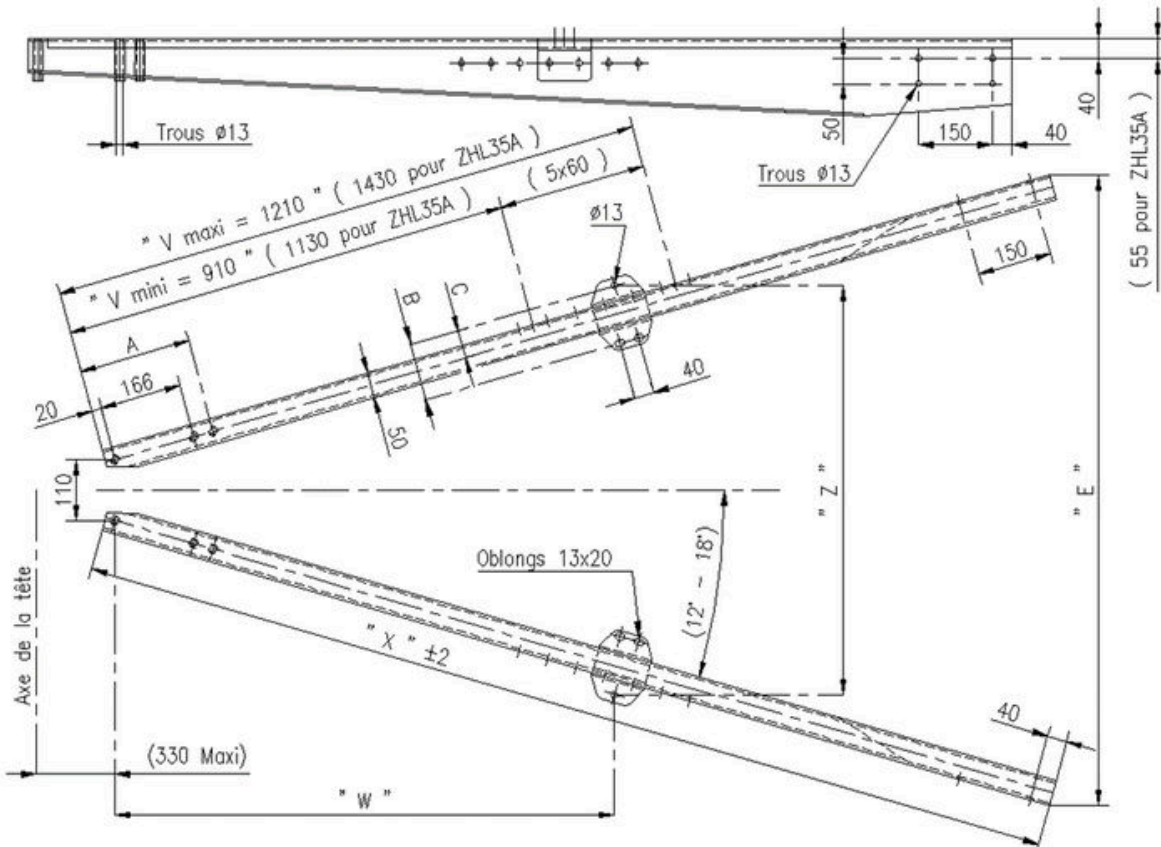

REF.	TYPE	GVW kg	VERT. LOAD kg maxi	X mm	"Z"		"W"		"E" mm	Additional fixation			Weight kg
					(V mini) mm	(V maxi) mm	(V mini) mm	(V maxi) mm		A	B	C	
3230119-200	ZHL7.5 A	1100-2100	75	2000	542-828	-	-	-	841-1512	-	103	50	14
3230119-250	ZHL7.5 A	1100-2100	75	2500	652-1044	-	-	-	1023-1873	-	103	50	18
3230095-200	ZHL15 A1	1100-2100	100	2000	590-792	719-989	-	-	947-1413	-	103	50	18
3230095-250	ZHL15 A1	1100-2100	100	2500	720-991	838-1180	-	-	1158-1742	-	103	50	22
3230005	ZHL20 A1	1100-2100	100	1750	588-765	712-950	859-829	1153-1115	878-1227	-	113	55	23
3230006	ZHL20 A1	1100-2100	100	2000	588-765	712-950	859-829	1153-1115	982-1381	-	113	55	25
3230007	ZHL20 A1	1100-2100	100	2250	588-765	712-950	859-829	1153-1115	1086-1536	-	113	55	27
3230009	ZHL27 A	1300-3500	300	2000	590-767	714-952	859-829	1152-1114	982-1381	207	109	56	30
3230010	ZHL27 A	1300-3500	300	2500	590-767	714-952	859-829	1152-1114	1190-1690	207	109	56	40
32300381	ZHL35 A	2000-3500 (1)	350	2000	683-904	808-1090	1074-1038	1367-1323	982-1381	207	110	57	42

(1) : Reinforced

OPTION :

- Linkage Kit ZHL15 to Rubber Axle 500 to 750Kg (C60) Ref: 3230502
- Linkage Kit ZHL15/20/27/35 to Rubber Axle 900 to 1800Kg (C80) Ref: 3230501



ALL OUR V-TYPE DRAWBARS FROM KNOTT ARE HOMOLOGATED (R55)

INERTIA BRAKING SYSTEM HYDRAULIC TRANSMISSION

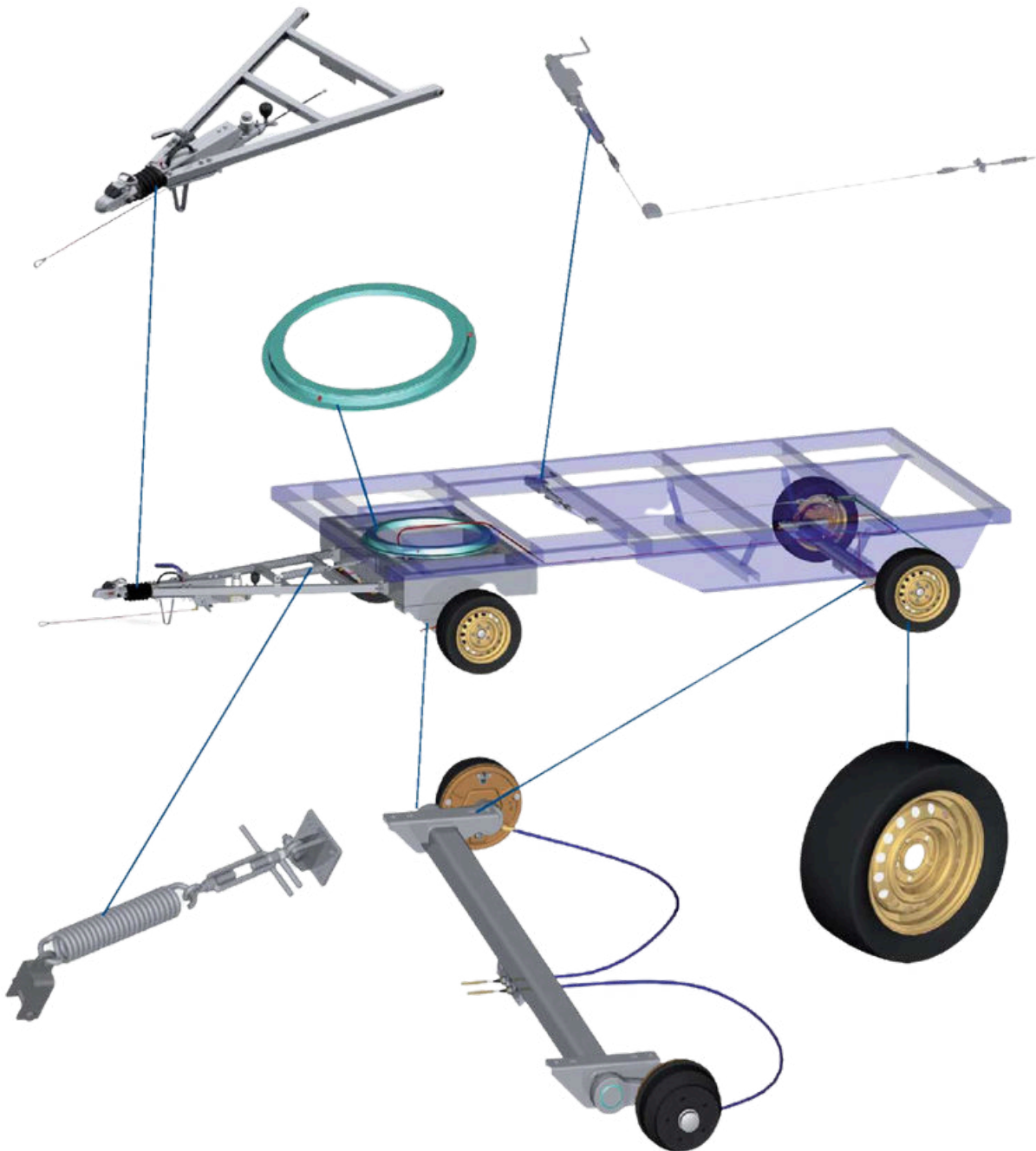

Components for trailers with a front axle and 2 or 3 axles, GVW from 2000 kg to 3500 kg

We offer all the KNOTT brand components mentioned above
Ideal for store-type trailers

ON REQUEST: PLEASE CONSULT US

AXLES WITH HYDRAULIC BRAKES

from 1300 kg to 1800 kg

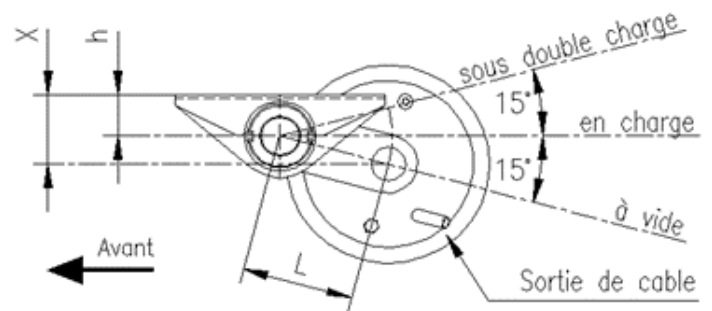
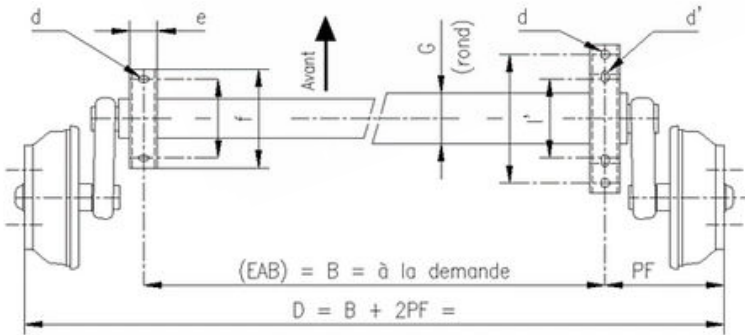
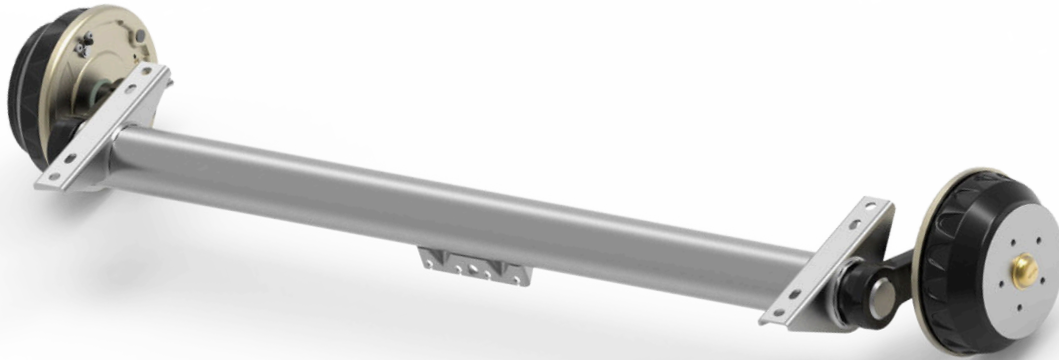

REF.	LOAD kg	* HUB drilling	BRAKE	2PF mm	FLANGE							X mm	Arm L	Body G	Weight kg
					l	l'	d	d'	e	f	h				
4472H29	1300	5x112	250x40	470	260	160/180	18.5	14.5	60	300	60	103	160	103	75
2941H29	1600	5x112	250x40	470	260	160/180	18.5	14.5	60	300	60	103	160	103	80
4116H29	1800	5x112	250x40	475	260	160/180	18.5	14.5	60	300	60	103	160	103	85
4117H29	1800 (1)	5x112	250x40	475	260	160/180	18.5	14.5	60	300	60	103	160	103	90

(1) : Reinforced axle with a 2.2T body for front axle

* For wheels with a positive offset of 25 to 35 mm

For 12" or 13" WHEELS (Double row angular contact ball bearings)

ALL OUR AXLES ARE EQUIPPED WITH HOMOLOGATED KNOTT BRAKES (R13)